

Venting Styles

Agricultural Elevator Buckets

Have you ever wondered why so many elevator buckets today are supplied already vented directly from the bucket elevator manufacturers? Simply stated, vents improve the efficiency of a bucket elevator on most agricultural products.

Bucket elevators are running faster than ever in order to quench the markets thirsty demand for greater capacity and throughput. By adding vents, denser products can be elevated and greater bucket speeds can be achieved, while still maintaining proper fill and clean discharge.

When elevator buckets fill, a pocket of air forms in the bottom since it cannot escape. While some products are not effected by this pocket of air, products such as meal, flour and mash feeds will tend to produce something known as "blow-back". This is seen by a puff of product as the bucket is loaded, which ultimately is caused by the pocket of air collapsing. Venting alleviates this "blow-back" by allowing air to move freely through the bucket to help cleanly and quickly seat product.

Venting works in a similar way for discharge. In this case, venting allows product to freely exit the elevator bucket while a non-vented bucket will typically produce a vacuum for product. When this happens product holds in the elevator bucket to cause back legging.

T.O.P.S. Inc. offers multiple styles of venting options for our customers to suit a variety of needs. However, not all grains accept venting, like rape seed and canola, or other products of similar characteristics with very low angle of repose. These type of products should not be used in a vented bucket. Please consult a T.O.P.S Inc. staff member for proper vent selection.

Vent #1

Same pattern as mounting holes will be drilled in body in either 9/32" or 11/32" holes.

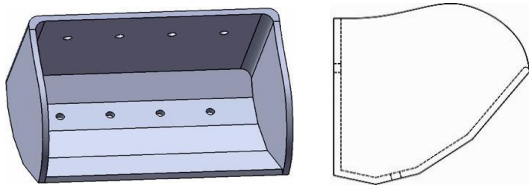

Vent #2

Vent pattern will consist of one row of 9/32" or 11/32" holes on 1-1/8" centers.

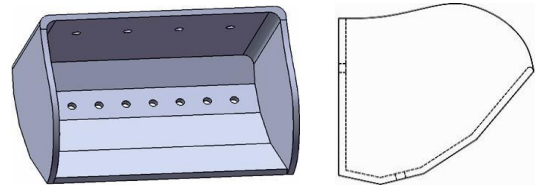

Vent #3

Vent pattern will consist of two rows of 9/32" or 11/32" holes on 1-1/8" centers.

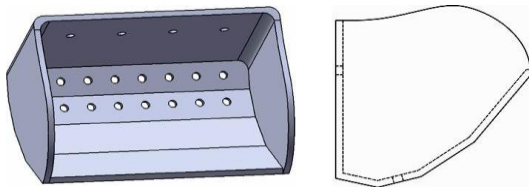

Vent #4

Vent pattern will consist of two rows of 9/32" or 11/32" holes on 1-1/8" centers with three holes drilled in each end.

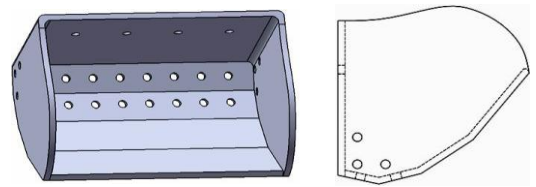

Vent #5

Vent pattern will consist of one row of 9/32" or 11/32" holes on 1-1/8" centers with three holes drilled in each end.

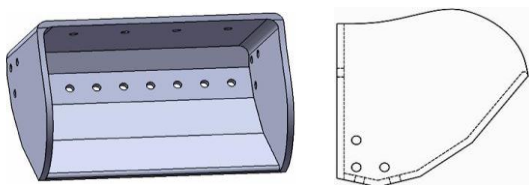

Vent #6 (Custom)

Vented per requested pattern.

